

# EXHIBIT 8.4C PROPOSED CAMPUS ENTRY - VAN NESS

**LEGEND**  
 Campus Boundary

**Campus Boundary**

- 32 Mathematics
- 38 School of Business and Public Administration/  
Career Services/Student Success Center
- 39 Administration/Financial Aid/Registrar
- 41 College of Arts and Science / Library
- 42 School of Engineering and Applied Sciences
- 43 Power Plant to be Phased Out. Potential to be  
Renovated For Academic Program.
- 44 New Campus Housing
- 46E Theatre of the Arts
- 46W Performing Arts
- 47 Sports Complex
- A New Academic campus building
- 56 Student Center
- 52 David A. Clarke School of Law
- 4225 Vacant Swing Space
- 4250 CAS & CAUSES permanent space
- F1 New Collegiate Athletic Field
- F2 U-12 Athletic Field

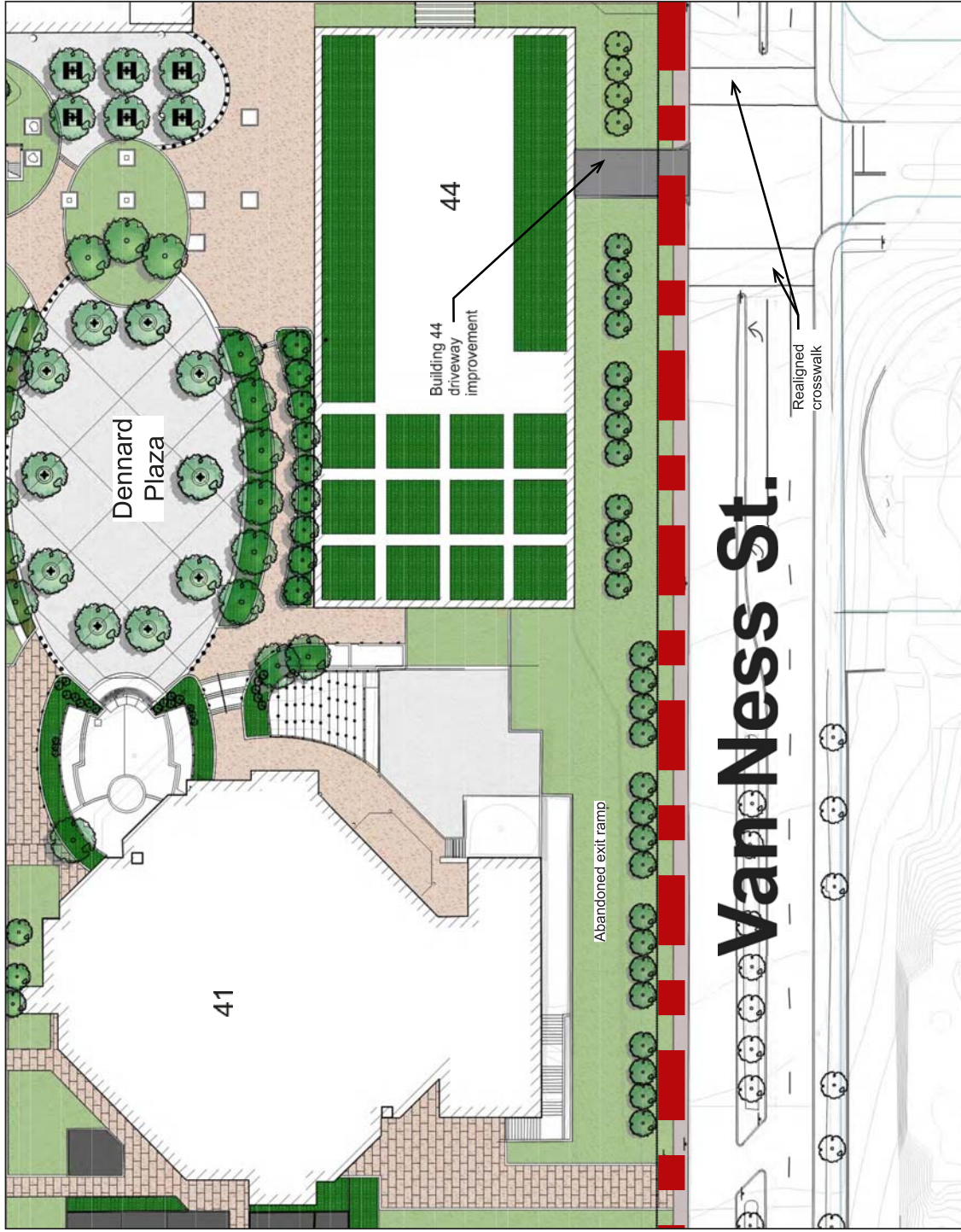

ZONING COMMISSION  
 District of Columbia  
 University of the District of Columbia, UDC  
 CASE NO. 2020-0003  
 EXHIBIT NO. 3AA

